

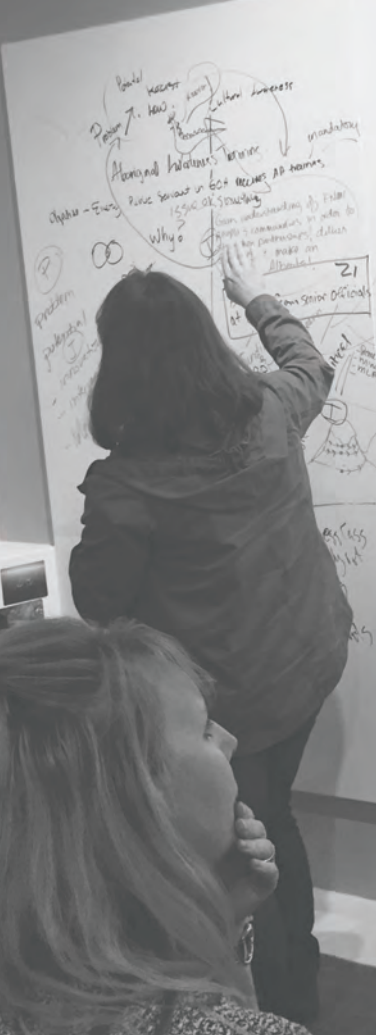

"THE CREATIVE ACT—the def

A SPACE TO THINK DIFFERENTLY AND MAKE IDEAS HAPPEN



LET'S BE A PART OF THE CHANGEMAKEERS

LET'S ACKNOWLEDGE AND APPRECIATE

LET'S TAKE



“For social innovation labs to be effective they need:

1. The right stewardship, which Skills Society has experience with through their Citizen Action Lab approach

2. The space and tools that elicit fresh thinking, collaboration, creative problem solving and building solutions as a collective

3. Access to the most promising practices emerging in the national and international community of social labs, which Ben Weinlick and Skills Society have been pro-active in developing.”

TIM DRAIMIN, Social Innovation Generation National



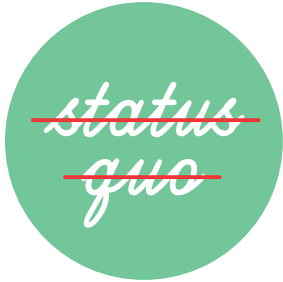

ABOUT ACTION LAB

The Action Lab is a social enterprise of Skills Society; an internationally recognized leader in social innovation and one of the largest disability service organizations in Edmonton—skillsociety.ca

With help from Manasc Isaac Architects the space was designed for hosting inspiring events, group collaboration, strategy sessions and social innovation. There isn't anything quite like the Action Lab in western Canada. The Action Lab experience promotes creativity, offers tools to help tap into collective wisdom and helps people prototype solutions to challenges they are working on.

Revenue from the Action Lab supports the employment of people with disabilities, innovative social change initiatives of Skills Society and subsidizes community groups who can't afford the full fee.

THE ACTION LAB STANDS ON THREE PILLARS

THE SPACE: Edmonton's most unique venue that you can rent for private events, workshops, meetings, strategic planning and more engaging collaboration

FACILITATION & WORKSHOPS: If you need facilitation of strategic planning and visioning we have amazing people who can design and facilitate a session to suit your needs

SOCIAL INNOVATION LAB: Stewardship of three-month deep dive processes to navigate complex social issues and co-design solutions with community



WORLD
ON THE
AS OF
CITIES



...OVERCOMES EVERYTHING.
- George Loeb

| Discovery | Strength | Connection | Rules | Action |
|-----------|----------|------------|-------|--------|
| | | | | |

Whiteboard content with various colored bars at the bottom.



THE SPACE

EDMONTON'S MOST UNIQUE VENUE THAT YOU CAN RENT FOR PRIVATE EVENTS, WORKSHOPS, MEETINGS, STRATEGIC PLANNING AND MORE ENGAGING COLLABORATION

When you rent the Action Lab, you are doing more than just renting an amazing space. A portion of the rental fee provides employment for people with disabilities who help coordinate Action Lab events and subsidizes community groups who are not able to afford the full fee.

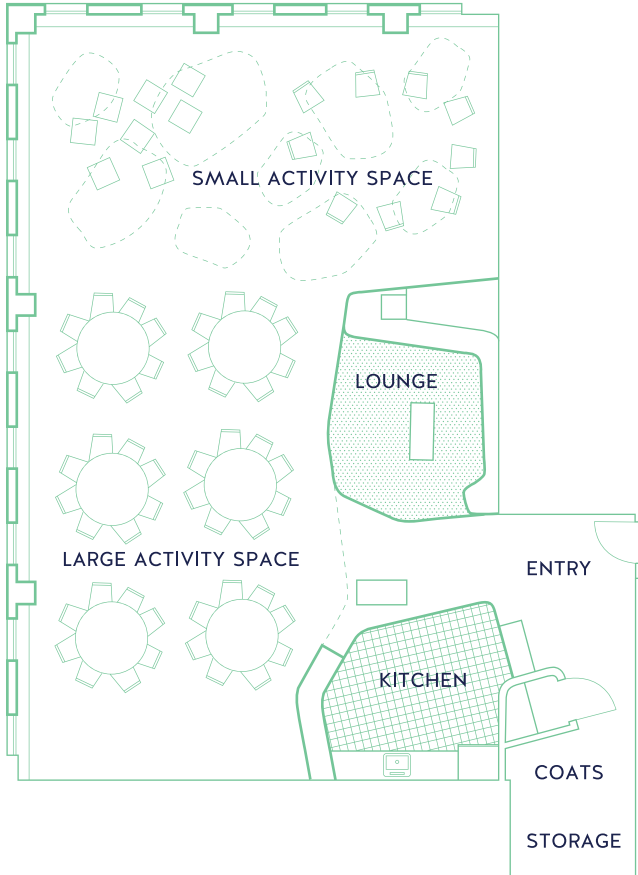

THE ACTION LAB FEATURES

- Space for up to 59 people comfortably
- A large lecture area with configurable table arrangement
- Four collaborative break out spaces with large white boards
- Sticky notes, sharpies
- A state of the art kitchen
- Coffee and tea
- Two state of the art projectors in separate spaces
- Digital smart board
- Wireless Microphones
- Wifi access
- Computer to run keynote or powerpoint
- Sound system for music
- Collaboration and problem solving tools

ACTION LAB RENTAL RATES

| CORPORATE & GOVERNMENT RATE | NON-PROFIT RATE | COMMUNITY RATE |
|---|---|---|
| <p>Full use of the space, technology and tools for up to 59 people.</p> <p>\$700 half-day, \$1200 full-day</p> | <p>Full use of the space, technology and tools for up to 59 people.</p> <p>\$450 half-day, \$700 full-day</p> | <p>Call or email and we'll figure out together a rate that works for your community group of up to 59 people.</p> |
| <p>Coffee & Tea \$1.00/person half day \$2.00/person full day</p> <p>Juice/Pop \$1.75/person</p> | <p>Coffee & Tea \$1.00/person half day \$2.00/person full day</p> <p>Juice/Pop \$1.75/person</p> | |





The CS STREET
A new Target Strategy
How to REFINANCE KLEEN
CONVERSATION STRATEGY
Serendipity
Strategic DIALOGUE
SUSAN'S PAPER
BBA
MIXED SHAREHOLDER ENGAGEMENT
RESEARCH SOCIAL SERVICES
SUSTAINABILITY
UNIVERSITY CAPTOWAN
SCALE SOLUTIONS
AHC
GIGA MARKING
WHAT DO YOU KNOW?
WHAT DO YOU NOT KNOW?
Map it out
And for Danica

LET'S GET ON WITH YOUR PAPER PAPER

FACILITATION & WORKSHOPS

IF YOU NEED FACILITATION OF STRATEGIC PLANNING AND VISIONING WE HAVE AMAZING PEOPLE WHO CAN DESIGN AND FACILITATE A SESSION TO SUIT YOUR NEEDS

FACILITATION

We can work with you to develop an impactful experience for your group. We have expertise in guiding visioning, strategic planning, world cafes, human centered design thinking and creative problem solving. In addition, a member of the Action Lab team is one of the few people in western Canada certified to guide LEGO® SERIOUS PLAY® strategy sessions.

Contact us for facilitation costs at info@skillssociety.ca or 780-496-9686.

WORKSHOPS

We offer community workshops throughout the year that anyone is welcome to attend.

- Culture and tools of social innovation
- Human Centered Service Design Thinking
- Collective Impact
- Diverse and vibrant workplaces
- Supporting the engaged citizenship of people with disabilities
- LEGO® SERIOUS PLAY®
- Being, Belonging, Becoming: Supporting Quality of Life

For further information about facilitation and workshops contact us.

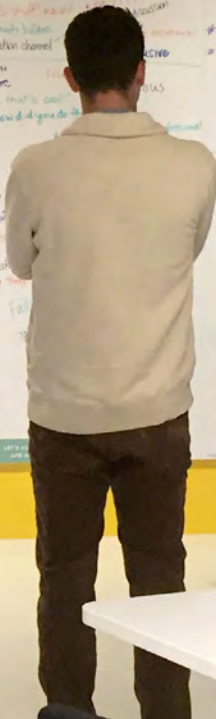
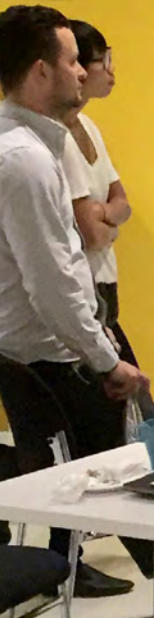

SOCIAL INNOVATION LAB

STEWARDSHIP OF THREE-MONTH DEEP DIVE PROCESSES TO NAVIGATE COMPLEX SOCIAL ISSUES AND CO-DESIGN SOLUTIONS WITH COMMUNITY

We are part of a social innovation ecosystem in Canada that is engaging in collective impact and change lab processes to tackle complex social challenges. A social innovation lab is a collaborative approach to navigating complexity that has a bias towards action and designing practical prototyped solutions alongside the people that are affected by an issue. Over the last five years Skills Society has invested in learning about and stewarding social innovation labs. Recently our leadership of a change lab focused on increasing the inclusion and citizenship experience of people with disabilities was recognized nationally and in the Stanford Social Innovation Review magazine.

HOW TO GET INVOLVED

Contact Ben Weinlick, MA—Senior Leader of Research and Social Innovation at Skills Society if you would like to participate or support a three-month deep dive innovation lab. ben@skillsociety.ca | 780-496-9686

WHAT HAPPENS DURING A THREE-MONTH DEEP DIVE?

- Convening diverse group of citizen explorers, policy makers, government champions, designers, journalists and academics
- On the ground research and sense making of an issue with community
- Identifying assumptions, needs, root causes
- Prototyping solutions, services, innovations
- Testing prototypes, getting feedback, iterating, refining
- Proposals of implementation of social innovation(s)

CONTACT US

If you have any questions about our services or would like to book the Action Lab please contact us:

#210, 10408-124 Street, Edmonton, AB, T5N 1R5
info@skillsociety.ca | 780-496-9686

skillsociety.ca



